

I.T.A. TOPOGRAPHICAL AND GENERAL SURVEY

NATURAL FEATURES, ANTIQUITIES, HISTORIC ASSOCIATIONS, ETC.

[BARONY OF COONAGH.....

TOWN OR VILLAGE DOON..... PARISH DOON..... COUNTY LIMERICK.....

TOPOGRAPHY

Brief description of outstanding scenic views in the district, natural attractions, or unusual topographical features.

Village of Doon nestles at western foot of Slieve Felim hills, which form a very picturesque background. From these hills, very lovely views of the surrounding country may be had. Away to S.E. are the lofty Galtees, between Doon and which, lies a very fertile plain, well watered but sparsely wooded.

GEOLOGY

Brief notes on unusual geological features, such as caves, eskers, etc.

Land is of limestone quality, rich and deep. Dairying is principal industry with cattle and pig raising. Hills are of round, smooth formation and little rock appears. Hillsides are fertile & are tilled in many places practically to summit.

MANSIONS, CASTLES AND ESTATES OF IMPOSING CHARACTER

*Location and brief description. Owner. Past associations. Libraries or art collections?
Gardens? Open to visitors? Admission charge?*

CASTLE GARDE. Lies about 2 miles east of Pallas gear on road to Doon. Very picturesque place, beautifully kept and believed to date from time of King John. To west is a fine stone peel tower and to east runs a comparatively modern section erected about 150 years ago. Owner Hugh Thompson, Esq., who inherited from his uncle, late Viscount Guillamore. (O'grady) The O'gradys have been associated with this place for close on 800 years. Castle was shelled many times & marks still remain on north wall. Was occupied by Cromwell's soldiers who made many raids from there. Present tower was built towards end of 16th century. It is the oldest inhabited place in Co. Limerick. No library or art collection save family portraits, etc. lovely garden but not open. House not open to visitors but interested parties may view from outside. See below.

ANTIQUITIES

Abbeys, Castles, Fortresses, Round Towers, Early Churches, Sculptured Crosses, Stone Circles, Ogham Stones, Cairns, Souterrains, Pillar Stones, Cromlechs, Forts, Rath, Moats, Tumuli or ancient monuments of any kind. Exact location of each with short description, noting condition, etc. Relate local legend or tradition associated with building or object. State if in charge of Office of Public Works. Right of way to public? Admission charge (if any). Name and address of caretaker, or where key is kept.

CASTLES.

CASTLETOWN CASTLE. One and a half miles south of Doon on road to Bala, standing on right bank of CAHERNAHALLIA River, is this most picturesque ruin (see picture).

Strongly built and occupying a prominent site, it is said to have been a stronghold of the O'Brien's, erected towards end of 16th century. A company of Cromwellian soldiers occupied it and from there made devastating raids.

A tower to south runs to a height of about 65 ft and outside measures about 20' x 14'. At S/W & S/E corners are ^{towers} ~~bastions~~ which ^{rise} ~~run~~ entire height of building. It is practically entirely covered with ivy and its features thereby concealed. The base of tower is used for storing turf and entry is thereby prevented. From outside it would appear that spiral stairs is mainly intact. Much of east wall to a height of about 20 ft remains but most of west wall and entire northern portion has fallen. On bank of ANDERSON. No care taken of ruin. What is left of it is sound. Ref:- Westropp, Ancient Castles of Co. Limerick. 88. CASTLETOWN, (25) Page 102.

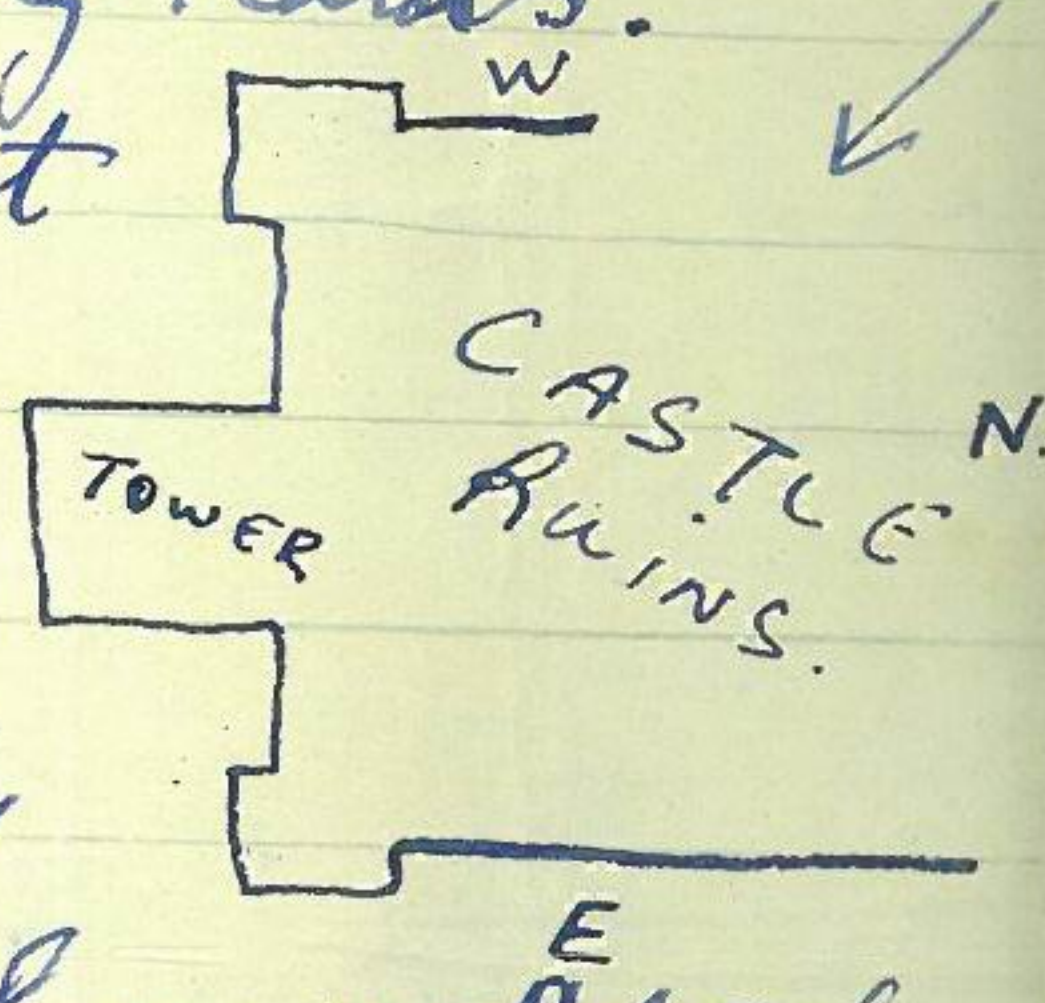

CASTLE GARDE. See Mansions Section.

CHURCHES.

CASTLETOWN. About 150 yards south of castle of same name is the little 15th century church of Castletown, much ruined & in receipt of no care. Was about 50 x 21 ft. Side walls about 12 ft high & 3 thick. East gable had narrow pointed window, widely splayed. In S. wall near E. gable is a narrow, pointed window & underneath, a broken, roughly carved font. Door which is almost entirely gone was in S. wall near W. gable. (Plain sheets of foolscap paper to be used, if necessary, for recording additional information). Arch overgrown with ivy. Lying about are a number of irregular, sandstone slabs (some used as stepping stones) with rude incised crosses and initials. Place has long since been abandoned as a burial ground & cattle have

I.T.A. TOPOGRAPHICAL AND GENERAL SURVEY

SPORTS AND GAMES

BARONY OF COONAH

TOWN OR VILLAGE DOON PARISH DOON COUNTY KILMERICK

ANGLING (Fresh water)

If there is only one river or lake in the parish this form (B) will suffice. For additional waters Form Ba to be used.

RIVER OR ~~LAKE~~ BILBOA Nearest point to town (distance) 1 mile

KINDS OF FISH HELD:

Salmon, Trout

AVERAGE WEIGHT OF:

Salmon 6 lbs (1944) Sea trout / Brown trout 4 lb.

BEST SEASONS FOR:

Salmon / Sea trout / Brown trout MAR TO July.

SUITABLE FLIES:

Salmon standard patterns, ~~affixat quills~~

Sea trout /

Brown trout standard patterns

State if angling is—"entirely free"; "free except on preserved stretches"; etc.

Trout fishing free. Preserved for salmon.

Preserved stretches with names and addresses of Proprietors:

Fishing for Salmon is prohibited by Board of Conservators. Poaching is a profitable trade in the area and the above weight is the average for this years "catch".

Owners of boats for hire, and charges per day:

Convenient angling centres (where accommodation is available):

DOON.

Local Angling Club / Membership Fee /

Secretary (and Address) /

SEA ANGLING

Brief notes on fishing grounds :

[Crossed out section]

Kinds of fish to be caught :

[Crossed out section]

Owners of boats, type of boats, and charges per day :

[Crossed out section]

Bait available locally ? Fishing tackle ?

Representative of B.S.A.S. or other sea angling Assn.

GOLFING

Name of Club TIPPERARY 8 miles No. of holes 9.

Situation and brief description of course :

Beside Tipperary town. Club house on course.

Name of Professional B. ?

Is there a clubhouse on course ? yes Licensed ? NO ?

Green fees (Visitors) : Per day / Per week /

1821/4/27

Church Sites. DOON.

In the village of Doon itself is the local burial ground of same name, where St Fintan founded his church, towards end of 6th century. Only foundation now remains.

GURTAVALLA. There is a very old burial ground which was the site of an early church, of which there is now no trace.

FORTS. ^{DUN BLEISCE} On hillside slightly ^{EAST} ~~west~~ of DOON is the fort known as DUN BLEISCE. Some maintain that BLEISC was a herd for the King of Baskel and this fort was for his protection. Others hold that it was the fort of BLEISCE, a lady of Illinute, who after being banished from court of Baskel, established herself, and held her court at Doon.

^{LIS NA GOIGEAL (Goizeal = Distaff)}
LIS NA GOIGEAL. (Fort of the Staffs) at COOGA, about one mile north of Doon, on road to Cappamore, is the fort of above name. Tradition has it that a herdsman when driving his flock by this fort one day when ground was very soft, saw gold glittering in the tracks made by the cattle. Not having time to collect it then, he stuck his staff in ground to mark the spot. When he returned later, he was amazed to see a forest of staffs facing him, rendering it impossible to locate his own.

HOUSE OF CANONS REGULAR. Where remnants of Doon's house now stands, about one mile S.E. of Doon, on road to Cappamore, there was once a House of Canons Reg. This was suppressed with all the other monasteries and granted to a family named HUNT, who converted it into a residence in due course. Underneath road, near gateway is a very old bridge of uncemented masonry, believed to date from time when above house flourished. Portions of a boundary wall near house are all that remain of this religious foundation.

I.T.A. TOPOGRAPHICAL AND GENERAL SURVEY

SPORTS AND GAMES

BARONY OF COONAGH

TOWN OR VILLAGE DOON PARISH DOON COUNTY LIMERICK.

ANGLING (Fresh water)

RIVER OR LAKE CAHERNAHALLIA Nearest point to town (distance) 1 1/2 Miles

KINDS OF FISH HELD:

Brown Trout

AVERAGE WEIGHT OF:

Salmon: ~~.....~~ Sea trout: ~~.....~~ Brown trout 1/4 lb.

BEST SEASONS FOR:

Salmon: ~~.....~~ Sea trout: ~~.....~~ Brown trout April - July.

SUITABLE FLIES:

Salmon ~~.....~~

Sea trout ~~.....~~

Brown trout standard patterns

State if angling is—"entirely free"; "free except on preserved stretches"; etc.

entirely free.

Preserved stretches, with names and addresses of Proprietors:

Owners of boats for hire, and charges per day:

Convenient angling centres (where accommodation is available):

DOON.
(Three Guest Houses)

Local Angling Club ~~.....~~ Membership Fee ~~.....~~

Secretary ~~.....~~

DATE 3/4/44

(Signed) P. J. Lynch

Surveyor.

RACING

(Including "Point-to-Point" and "Flapper" meetings)

No. of meetings normally held during the year.....

Under which rules?.....

Situation of course.....

HUNTING

Hounds which hunt in the district:

Foxhounds *Seventeen Black & Jaws come to*

Harriers *district occasionally. Not a*

Beagles *hunting country.*

COURSING

Name of Club *Doon C. Club*: Meeting held annually? *yes. No.*

GREYHOUND RACING

Name of Company *Limerick City 19 miles.*

Races on (nights) *Fri & Sat at 8.15 P.M.*

SHOOTING

Brief notes on shooting areas, stating kinds of wild fowl or game, and if free shooting is available:

Rough shooting in plenty to be had over Doon Hill and adjoining areas. Grouse fairly plentiful. Pheasant also to be had in small numbers. Ruffe, duck curlew & plovers are also found in small numbers

If preserved, give names of landowners or lessees and addresses:

.....
.....
.....

Shooting Club..... Secy.....

CLAY PIGEON SHOOTING

Name of Club..... Competitions held?.....

ROWING AND SAILING

Rowing or yacht clubs, with address of club-house.

.....
.....
.....

GAMES AND RECREATIONS

Name of Club or Committee concerned with the following :
 (In each case give location of sports ground or recreation hall)

Gaelic Football *yes. Junior Team.*
 Hurling *yes. Junior Team.*
 Handball *NO* Handball alley? */*
 Soccer *NO*
 Rugby *NO*
 Cricket *NO*
 Hockey *NO*
 Bowls *NO*
 Bowling (on public roads) *NO*
 Lawn Tennis *NO* Kinds of courts */*
 Croquet *NO*
 Billiards *NO*
 Badminton *NO*
 Table Tennis *NO*
 Bridge Club *NO*
 Other games or recreations (inc. "Cross Roads" dancing) */*

ATHLETICS AND CYCLING

Name of Club..... Events held under rules of.....
 do.

ANNUAL EVENTS

Give list of annual events held in the town or parish, naming promoters (Clubs, etc.)
 in each case. Include pilgrimages and patterns.

Coursing meeting Promoters *Doon B. Club.*
Usually held in month of December.

DATE *3/4/44.*

(Signed) *P. J. Lynch.*
Surveyor.

ACCOMMODATION

PARISH.....

DOON.

*Copy typed & filed
2.2.44*

BARONY.....

COONAGH

COUNTY.....

LIMERICK.

TOWN OR VILLAGE.....

DOON.

HOTELS	NUMBER OF				Licensed	REMARKS	RESTAURANTS AND CAFÉS
	Guest Bedrooms	Baths	Lavs. (state kind)	Public Rooms			
/							
<u>GUEST OR BOARDING HOUSES</u>							
Miss M. Ramsford	3	1	1	1	no	Looks well kept & clean. Would make a nice guest house.	
Miss M. Hayes	2	—	1	3	yes	Boarding House. Very untidy. Proprietress very old.	
Miss A. Ryan N. 2 3	—	—	1	2	yes	This house is known as "the Hotel." No sign on view. Now carries on a private B.H. Would be a nice G.H.	

DATE.....

3/4/44

(Additional Forms to be used if necessary)

(Signed).....

P. J. Zwick
Surveyor

LIBRARIES

Public Libraries *County Library (Branch) in Monastery in
soon and also at house of Francis O'Connell, Castle-
garden.*
Private Lending Libraries *In Convent of Mercy, Doon.*

CHURCHES AND SERVICES

R.C. Church *DOON* Services (Sundays) *8.30 & 11.*
Old time all year round.
Church of Ireland.
DOON. *10.30. official time.*
Service only every second Sunday.

POSTAL FACILITIES

Location of Post Office *DOON*
Business (? M.O., Telegraph, Telephone) *All Branches.*

BANKING

Banks *Ch. & S. Bank.*

SPORTS AND PHOTO SUPPLIES

Sports Dealers *Michael Carey & Mrs Hayes.*
*Business carried on for small items. Big stocks
not carried. Both in village.*
Photographic Stores *The Medical Hall, Doon.*
Prof: Mr. Wm Gannon, Main St., Doon.

SWIMMING POOLS AND BATHS

Swimming Pool?..... Location.....
Public Baths?..... Location.....

SOCIAL CLUBS, CULTURAL SOCIETIES, &c.

Social Clubs *Ancient Order of Hibernians*
Meeting house inside gate of R. C. Church.
Card games, etc carried on.

Cultural Societies

INDUSTRIES AND HANDCRAFTS

Industries *Dairying is principal industry and*
nearly is an up to date creamery turning out
butter of excellent quality. Cattle and pig
raising is also carried on, on a large scale.

Handcrafts or Cottage Industries (Give names of craftsmen, employer, &c.):

PUBLIC MONUMENTS

(Brief description ; inscription to be quoted)

IMPORTANT PUBLIC BUILDINGS

(Give brief notes on architectural features)

Very fine R. C. Church overlooking village. Splendid
Convent in village itself run by Sisters of Mercy.
Very pretty Church of Ireland, built of cut stone
and having a quaint belfry, lies $\frac{1}{4}$ mile north
of village. Monastery of Irish Whistler Brothers
is a substantial building and well kept.

SCHOOLS AND COLLEGES

Boys *Secondary school in town run by Irish C. Brothers.*
Girls *" " " " " " " " Sisters of Mercy.*
National Schools are also run by both the above Communities.
Mixed National Schools at CAHERNAHALLIA; GURTAVALLA and
FOILECLEARA.

HOSPITALS

HISTORIC SITES

Royal Seats, scenes of historic events—battles, mass meetings, historic festivals, &c. Location.
Landowner. Historical or traditional notes.

Castle had
immensely thick
walls

HISTORIC HOUSES ; BURIAL PLACES

(a) Birth places or one-time residences of distinguished Irishmen or other personalities.
Location and description. Present owner or occupant. (b) Burial places of distinguished personalities.

N. CASTLE GARDE. This was the property of the O'Grady family - Viscounts Guillamore and was got ready for and occupied by the 2nd son of the first Viscount. This first Viscount figured in trial of Robert Emmet. (see mansions section.)

Samon o'Caime, noted raparee, buried in Doon churchyard (Lewis - p. 484) Refer to famous Gaelic song etc.

But this is contradicted by other sources see account in Field Gde. (under Cappagh White, G. Jeph.)

SPAS OR MINERAL SPRINGS

Spas formerly in use. Location and present condition. Access. Right of way to public?
Mineral content and curative properties so far as known locally.

stone

see access to ruin.

CURIOSITIES

Curious objects, structures, monuments, landmarks, sights, etc. For example, Wishing stones or "chairs," freaks of nature (i.e. grotesque rock formations)—in fact, any scene or object which may be regarded as queer, quaint or mirth-provoking. Location and description. Any story or legend to be related.

TOBAR NA GOIRTEACH. (Rag well) In Devanes field at Kilmoylean, beside house of George Allis, 500 yds south of village is the above well. It lies in a hollow rock within the trunk of a great Poplar tree. Originally it lay at base of rock, which in turn lay at base of tree but as the tree grew, its roots almost entirely covered the rock and well, with the result that the water rose and filled the hollowed crown of rock. It was once considered a Holy Well as its name would indicate but its history has long since been forgotten.

OLD BRIDGE, TOOMALINE. Near gateway to remains of Toomaline Ho. & under public road is a very old bridge, spanning a little stream. Constructed of irregular, uncemented stones, it is believed to date from the time when there was a house of Canons Regular at Toomaline. Bridge very low and flat, only ^{CUSTOMS, PATTERNS, ETC.} ~~about eight~~ ^{feet} high.

Brief account of old customs, traditional cures, etc., still practised in the district. Pilgrimages to Holy Wells, Shrines, etc. Patterns.

St Fintan's Well. Beside Garda Bks, in field of Mr J. Hayes, Kilmoylean, is well of St Fintan, where rounds are made on 3rd January (Feast-day) in each year. Cures for many ailments have been attributed to its waters. Nowadays only very few frequent it.

DATE 8/4/44.

(Signed)

A. J. Lynch

Surveyor.