

LOT 137.

Nos. on Map	DENOMINATIOXS	Grantees' and Lessees' Names	Gale Days	Yearly Rent	TENURE	OBSERVATIONS
Map No. 10 221C	Little Somerville and Laurel Hill Cottage, Area, 10a. 3r. 34p.	George Davis	1st May and 1st Nov.	£ 31 s. 4 d. 2	Lease, dated 19th April, 1785, for three lives renewable for ever on payment of a peppercorn fine, made between Edmond Henry Pery of the one part, and George Davis of the other part.	The rent set out in the Rent Column may be liable to adjustment under the Local Government Acts. The Landlord's part of the Original Lease and Renewals of 1800 and 3841 will be handed to the Purchaser. This rent is paid by Mr. R. S. Chatterton, Belmont, Raheny, Co. Dublin, Agent for the Lessee.

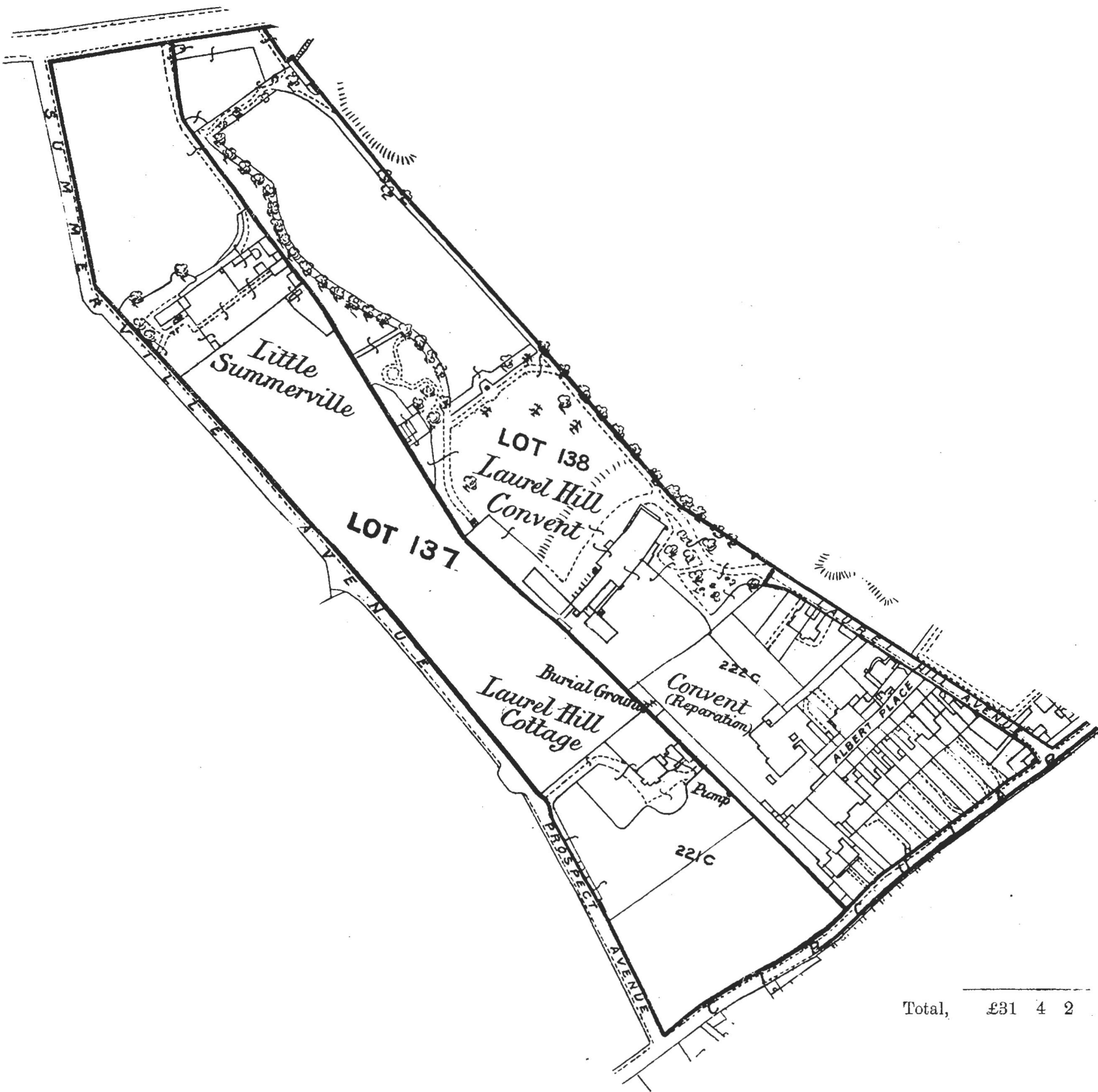

The premises are described in the Lease as "All that and those part of the Lands of Courtbrack, containing by common estimation 7 acres and 19 perches, plantation measure, be the same more or loss, as described in a Map hereunto annexed, bounded on the North-west by the River Shannon, on the South-east by the Circular-road, on the West by the new road to the river, and upon the East by the holdings of William Wallace, Esquire, situate, lying, and being in the South Liberties of the City of Limerick."

The Grant reserves liberty of hunting, hawking, fishing, and fowling.

The Grantee covenants to keep in repair the premises and all improvements, inevitable accidents excepted.

Proviso for surrender by Lessee on any 1st May on giving 12 months' previous notice in writing and paying all rent.

The Grant also reserves all mines, minerals, and coals, and contains a covenant for perpetual renewal on payment of a peppercorn fine.

Total, £31 4 2

The Estimated Tenement Valuation of this lot is £68.