

LOT 145.

Nos. on Map	DENOMINATIONS	Grantees' and Lessee's Names	Gale Days	Yearly Rent	TENURE	OBSERVATIONS
Map No. 4 174	Part of 20 Catherine-street 13, 14, 15 and 16 Cecil-street, Upper	Charles O'Hara	1st May and 1st Nov.	£ s. d. 35 0 10	Fee-farm Grant, dated 26th January, 1858, made between William Henry Tennison, Earl of Limerick, of the one part, and Charles O'Hara of the other part, in conversion of a renewable lease dated 1st May, 1813, from Edmond Henry, Earl of Limerick, to Michael Slattery.	The rent set out in the Rent Column is an adjusted rent. The Landlord's part of the Fee-farm Grant and of the Original Lease will be handed to the Purchaser. This rent is paid by Messrs. James Nash & Son, O'Connell-street, Limerick, Agents for the Grantee

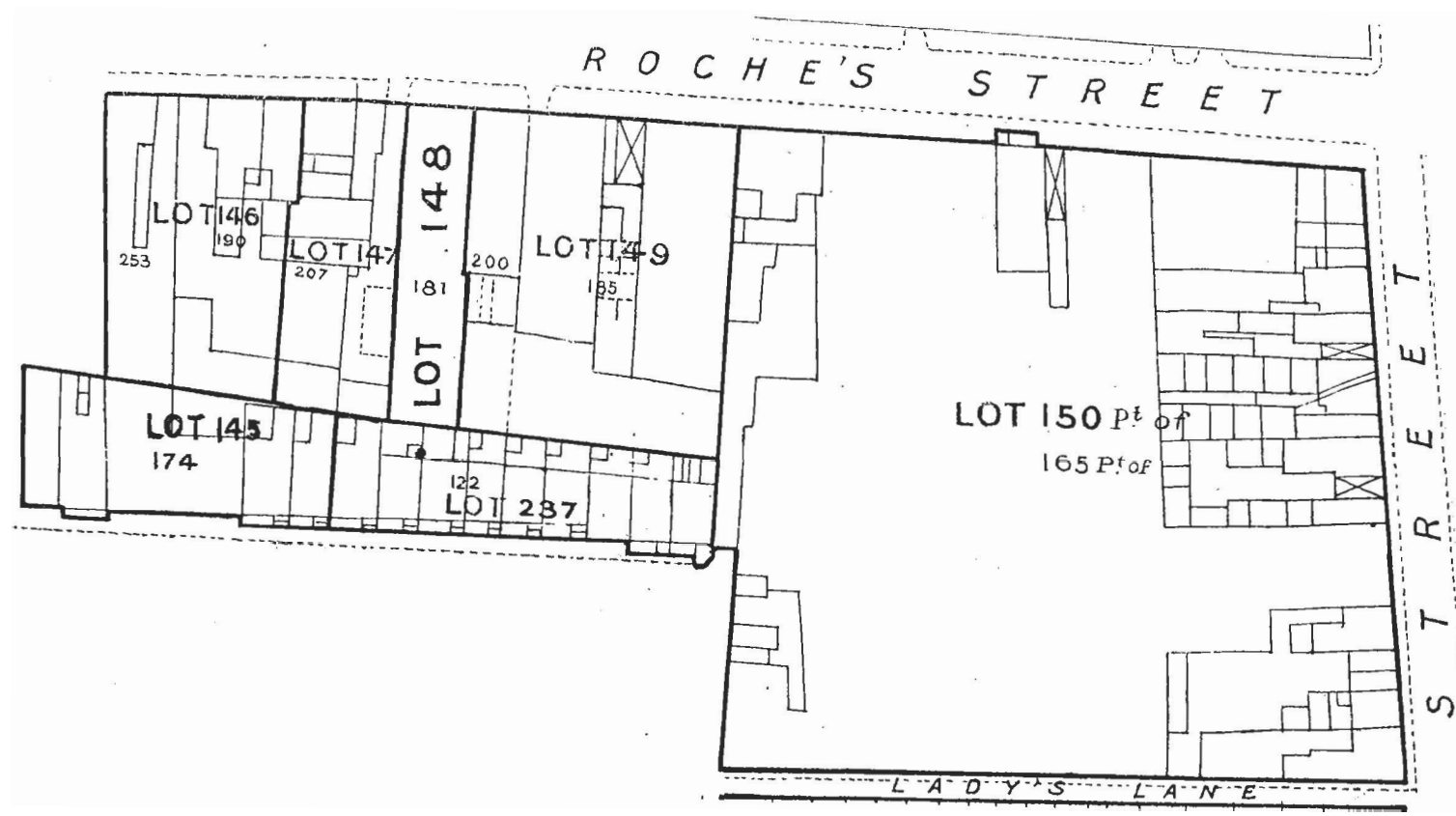

The premises are described in the Grant as "All that and those the aforesaid plot of ground, part of South Priors Land, formerly situate in the South Liberties of the City of Limerick, but now by virtue of the Municipal Boundaries Act, situate within the Borough of said City of Limerick, containing in front, on the North, bounded by Catherine-street, 66 feet, on the South, bounded by Pryce Peacock's holdings, 48 feet and an half, on the West, bounded by Cecil-street, 150 feet, and on the East, by the back concerns of Roche's-street, 148 feet, be the same or any of them more or less as appears by the map annexed to said Lease."

The Grant reserves all mines, minerals, and royalties.

The Grantee covenants to keep in repair the premises and all improvements, and preserve the same from all manner of waste and destruction.

Total, £35 0 10

The Estimated Tenement Valuation of this lot is £87.