

Nos. on Map	DENOMINATIONS	Grantees' and Lessees' Names	Gale Days	Yearly Rent	TENURE	OBSERVATIONS
<p>Map No. 7</p> <p>252</p>	<p>9 and 10 Roche's-street</p> <p>11 Roche's-street</p> <p>Provincial Hotel, Catherine-street</p> <p>66 Catherine-street</p>	<p>Franc-S de Saenger, Widow</p>	<p>25th March and 29th Sept.</p>	<p>£ s. d.</p> <p>2 14 0</p>	<p>Fee-farm Grant, dated 9th August, 1882, made between William Hale John Charles, Earl of Limerick, of the one part, and Frances de Saenger, widow, of the other part, in conversion of a Renewable Lease, dated 11th May, 1792, from Lord Viscount Pery to William Reid.</p> <p>The premises are described in the Grant as "All that and those a plot of ground on the East side of Roche's-street, bounded on the West in front by Roche's-street, and containing 54 feet 10 inches on the East, in rere by Oliver O'Brien's holdings, and containing 48 feet 6 inches, on the North by William Hickey's holdings, and containing 84 feet 10 inches, and on the South by the house then tenanted by the Widow Dunne, and containing 84 feet 6 inches, all which said granted premises are situate, lying, and being in Roche's-street, Parish of St. Michael's, and is part of South Priors Land, in the South Liberties of the City of Limerick, and non-within the Borough of Limerick."</p> <p>The Grantee covenants to keep in repair the premises, and all improvements, the accidents of fire, war, and general rebellion only excepted.</p>	<p>The rent set out in the Rent Column may be liable to adjustment under the Local Government Acts.</p> <p>The Landlord's part of the Fee-farm Grant and of the Original Lease will be handed to the Purchaser.</p> <p>This rent is paid by Mrs. Marian F. Powell, 2 Rostrevor-terrace, Clontarf, Dublin.</p>
<p>197</p>		<p>John Molony</p>	<p>25th March and 29th Sept.</p>	<p>8 2 1</p>	<p>Fee-farm Grant, dated 14th December, 1872, made between William Hale John Charles, Earl of Limerick, of the one part, and John Molony of the other part, in conversion of a Renewable Lease, dated 22nd February, 1800, from Edmond Lord Baron Glenthworth to William Reid.</p> <p>The premises are described in the Grant as "All that and those the said plot or parcel of ground, part of South Priors Land, described in a map annexed to said Original Lease, containing on the West, to Roche's-street, 54 feet, on the</p>	<p>The rent set out in the Rent Column may be liable to adjustment under the Local Government Acts.</p> <p>The Landlord's part of the Fee-farm Grant and of the Original Lease and such of the Renewals as are forthcoming will be handed to the Purchaser.</p> <p>This rent is paid by Mrs. Marian F. Powell, 2 Rostrevor-terrace, Clontarf, Dublin.</p>

LOT 154—continued.

Nos. on Map	DENOMINATIONS	Grantees' and Lessees' Names	Gale Days	Yearly Rent	TENURE	OBSERVATIONS
Map No. 7 197 contd.		John Molony, continued ... Brought forward,		£ s. d. 10 16 1		East, bounded by Oliver O'Brien's holdings, 54 feet, and from front to rere 84 feet, be the same more or less, and situate in the Parish of St. Michael and County of the City of Limerick."

The Grant reserves all mines, minerals, and royalties, coal and slate.

The Grantee covenants to keep in repair the premises, and all houses, edifices, buildings, and other improvements.

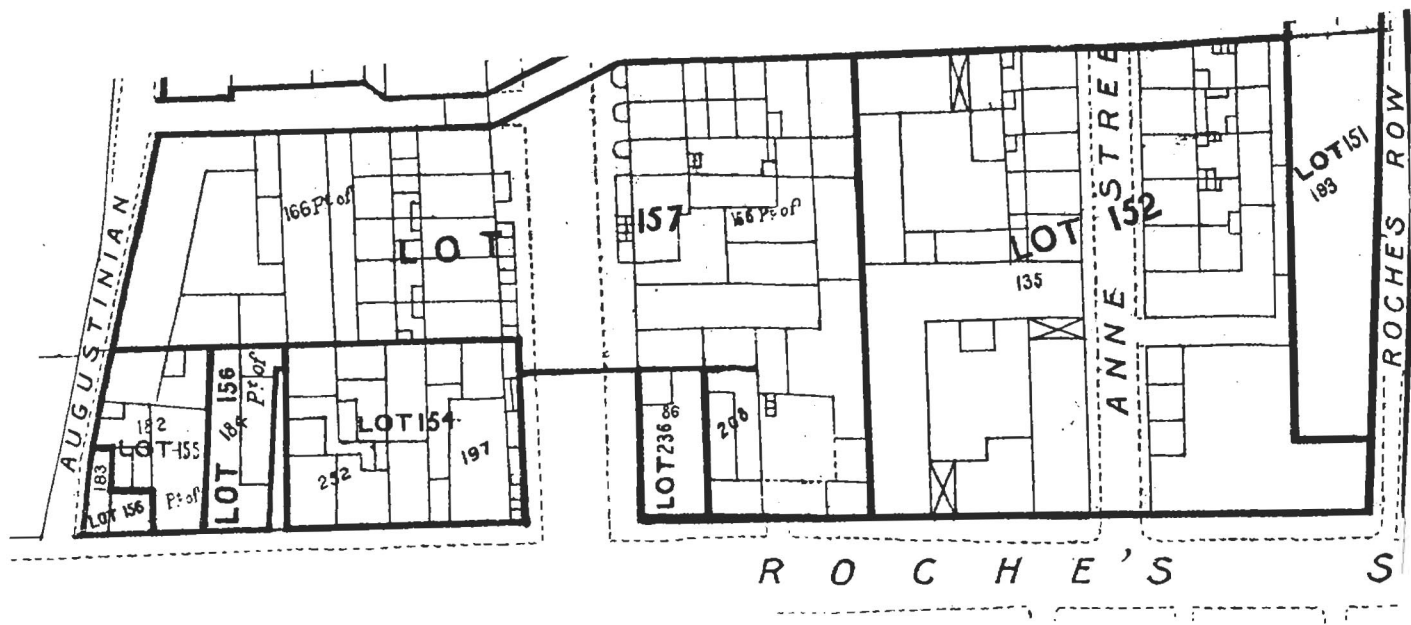

Total, £10 16 1

The Estimated Tenement Valuation of this lot is £114