

# LOT 156.

Nos. of Map	DENOMINATIONS	Grantees' and Lessees' Names	Gale Days	Yearly Rent	TENURE	OBSERVATIONS
Map No. 7 183	5 and 6 Roche's-street  8 Roche's-street	... John Casey	... 25th March and 29th Sept.	£ s. d. 13 0 6	Lease, dated 17th November, 1893, made between William Hale John Charles, Earl of Limerick, of the one part, and John Casey of the other part, for the term of 99 years from the 29th day of September, 1893.  The premises are described in the Lease as "All that and those the houses and premises in Roche's-street and Augustinian-lane, measuring in front to Roche's-street 33 feet 4 inches, and in front to Augustinian-lane 44 feet, bounded on one side by Roche's-street aforesaid, on another by Augustinian-lane aforesaid, on another by premises in possession of Patrick Shanny, and on another by premises in possession of Mrs. Carrick, all which said premises are situate in the Parish of Saint Michael and City of Limerick, and are more particularly delineated on the Map drawn hereon."  The Lease reserves all mines, minerals, quarries and all other royalties.  The Lease contains covenants by the Lessee to expend in repairing and improving the houses then standing on the premises the sum of £200 at least, to make sewers, etc., to the satisfaction of the Sanitary Authorities, to pay Sanitary Rates, to keep in repair, against assignment without Lessor's consent, to insure for £700 in the joint names of the Lessor and Lessee, and clause of view:	The rent set out in the Rent Column is an adjusted rent.  The Landlord's part of the Original Lease will be handed to the Purchaser.  This rent is paid by Mr. John Casey, Roche's-street, Limerick.
Map No. 7 184		... Patrick Bran	... 25th March and 29th Sept.	6 0 0	Lease, dated 31st December, 1890, made between William Hale John Charles, Earl of Limerick, of the one part, and Patrick Ryan of the other part, for the term of 99 years, from the 29th day of September, 1890, in consideration of having improved and repaired the premises.  The premises are described in the Lease as "All that and those the house and premises in	The rent set out in the Rent Column may be liable to adjustment under the Local Government Acts.  The Landlord's part of the Original Lease will be handed to the Purchaser.  This rent is paid by Mr. John O'Malley, Roche's-street, Limerick.

# LOT 156—continued.

Nos. on Map	DENOMINATIONS	Grantees' and Lessees' Names	Gale Days	Yearly Rent	TENURE	OBSERVATIONS
-------------	---------------	------------------------------	-----------	-------------	--------	--------------

Map No. 7						
184	_____	... Patrick Ryan, continued ...			£ s. d.	
contd.					Brought forward, 19 0 6	

Roche's-street, measuring in front to said street 29 feet, in the rere 36 feet 3 inches, and in extreme depth from front to rere 83 feet 3 inches, bounded in front by Roche's-street, in the rere by O'Connell's slaughter house, on the West by premises in the possession of Mrs. Carrick and W. Butler, and on the East partly by a lane, and partly by P. O'Callaghan's premises, all which said premises are situate in the Parish of St. Michael and City of Limerick " and delineated on the map.

The lease reserves all mines, minerals, quarries, and all other royalties.

The Lease contains covenants by the Lessee to make sewers, etc., to the satisfaction of the sanitary authorities, to pay sanitary rates, to keep in repair, against assignment without Lessor's consent, to insure for £500 in the joint names of the Lessor and Lessee, and clause of view.

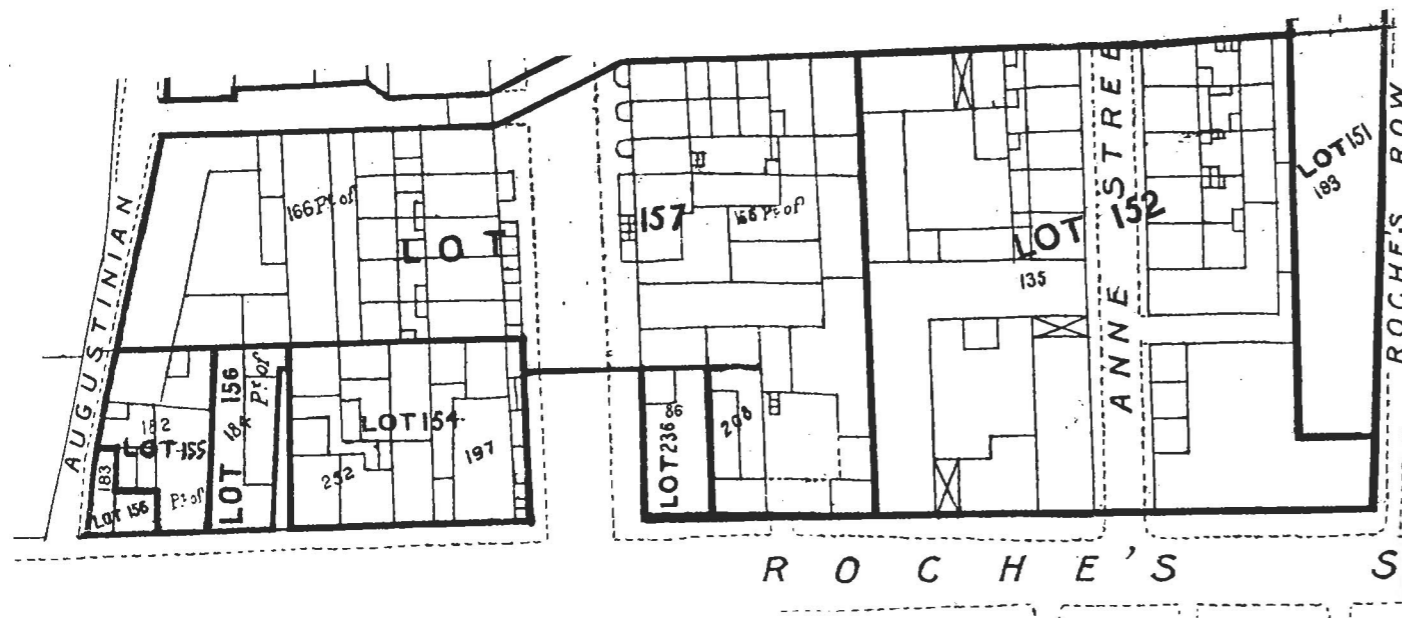

Total, £19 0 6

The Estimated Tenement Valuation of this lot is £34.