

LOT 239.

Ground Rents issuing out of part of the Lands of Ballinacurra (Bowman), and part of the Lands of Ballinacurra (Hart), in the Liberties of the City of Limerick, held with others under Fee-Farm Grant, dated 7th September, 1857, at the yearly Fee-Farm Rent of £147 13s. 10d., adjusted to £137 7s. 8d., from Huson B. Swete to the Earl of Limerick.

Nos. on Map	DENOMINATIONS	Grantees' and Lessees' Names	Gale Days	Yearly Rent	TENURE	OBSERVATIONS
Map No. 11 3bc	Ballinacurra-road Templeville House Offices and Land, Quaker Cemetery	... Laurence Blewett ...	25th March and 29th Sept.	£ s. d. 18 13 4	Lease, dated 15th August, 1777, made between the Reverend William Cecil Pery, Dean of Killaloe, of the one part., and Laurence Blewett of the other part, for the term of 900 years, from the 25th March, 1777.	The rent reserved in the Original Lease is £20 4s. 11½d., Irish. The rent set out in the Rent Column is the adjusted rent, present currency. The Landlord's part of this Lease is not forthcoming. A certified copy of the tenant's part will be handed to the Purchaser. This rent is paid by Mr. Thomas Hassett, O'Connell-street, Limerick.

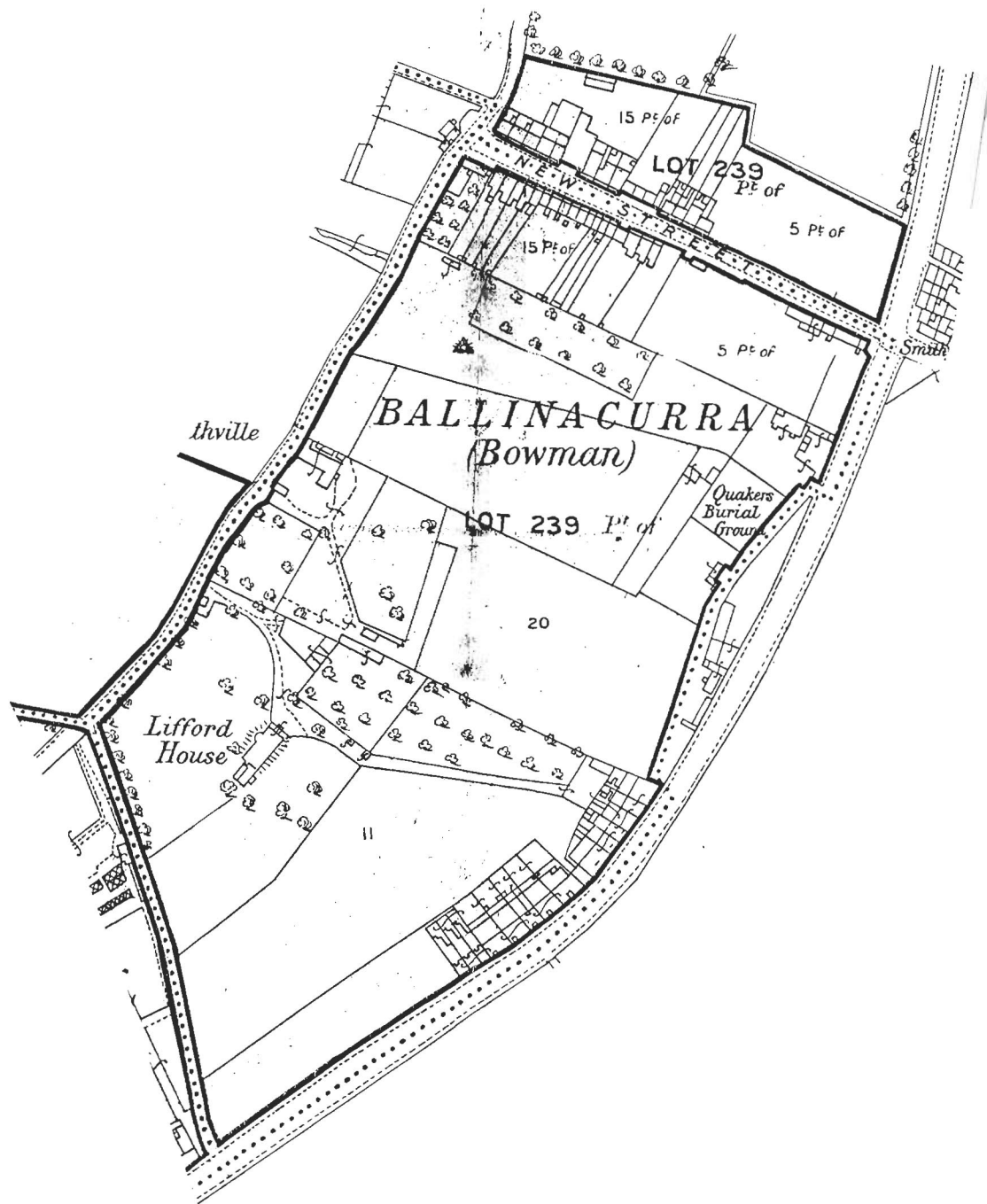

The premises are described in the Lease as "That part of the Lands of Ballynacurra Bowman in the South Liberties of the City of Limerick, containing 4 acres 1 rood and 32 perches, more or less, bounded on the East by a new stone wall, on the West by Mr. McAuliff's field, on the North by the green road, and on the South by the turnpike road," according to a Map thereof thereto annexed.

The Lease reserves all timber and timber trees, mines, minerals, coal, slate and other quarries, and liberty to hunt, hawk, fish, and fowl.

The Lessee covenants to keep in repair all houses, buildings, drains, fences and other improvements, accidents of fire, war and general rebellion only excepted.

The Lease contains a provision that the Lessee should be bound by all covenants and clauses in the head Lease, and also a provision enabling the Lessee to surrender on any 25th March after first three years of the term on giving 12 calendar months' notice, attested by two witnesses, and paying all rent.

Nos. on Map	DENOMINATIONS	Grantees' and Lessees' Names	Gale Days	Yearly Rent	TENURE	OBSERVATIONS
				£ s. d.		
			Brought forward,	18 13 4		
Map Nos. 10 & 11 Bc.	Premises, New-street and Military-road, and valuable Building ground	Bridget Punch, widow ...	25th March and 29th Sept.	65 0 0	Lease, dated 15th April 1893, made between William Hale John Charles, Earl of Limerick, of the one part, and Bridget Punch, widow, of the other part, for the term of 99 years, from the 25th March, 1893.	The rent set out in the Rent Column may be liable to adjustment under the Local Government Acts. The Landlord's part of the Original Lease will be handed to the Purchaser. This rent is paid by Mrs. Bridget Punch, New- street, Limerick.

The premises are described in the Lease as " All that and those the three plots of ground situate at the New street and Military road Limerick, part of the lands of Ballinacurra, in the Parish of Saint Michael, partly within and partly without the Municipal Boundary of the City of Limerick, on portion of which premises there now stands some houses with the appurtenances and which plots of ground are marked No. 1, No. 2, and No. 3 on the Map thereof annexed hereto, No. 1 containing in front to the New street 359 feet, on the West side 174 feet 6 inches, and on the East side 160 feet 6 inches; No. 2 containing in front to the New street 369 feet 6 inches, on the West 185 feet, and on the East side 174 feet 6 inches: No. 3 containing in front to Military road 140 feet, on the South 75 feet, on the North 185 feet, and on the East 161 feet."

The Lease reserves all mines, minerals, quarries and all other royalties.

The Lease contains covenants by the Lessee to expend £500 within two years from date of Lease in buildings, to make sewers, etc., to the satisfaction of the Sanitary Authorities, to pay sanitary rates, to keep in repair, against assignment without Lessor's consent, not to permit obnoxious trades or licensed premises for sale of malt, beer or spirits, save in the house then used as a public-house, to insure in the joint names of the Lessor and Lessee for £300 for each house on Military road, and £150 for each house at New street, and clause of view.

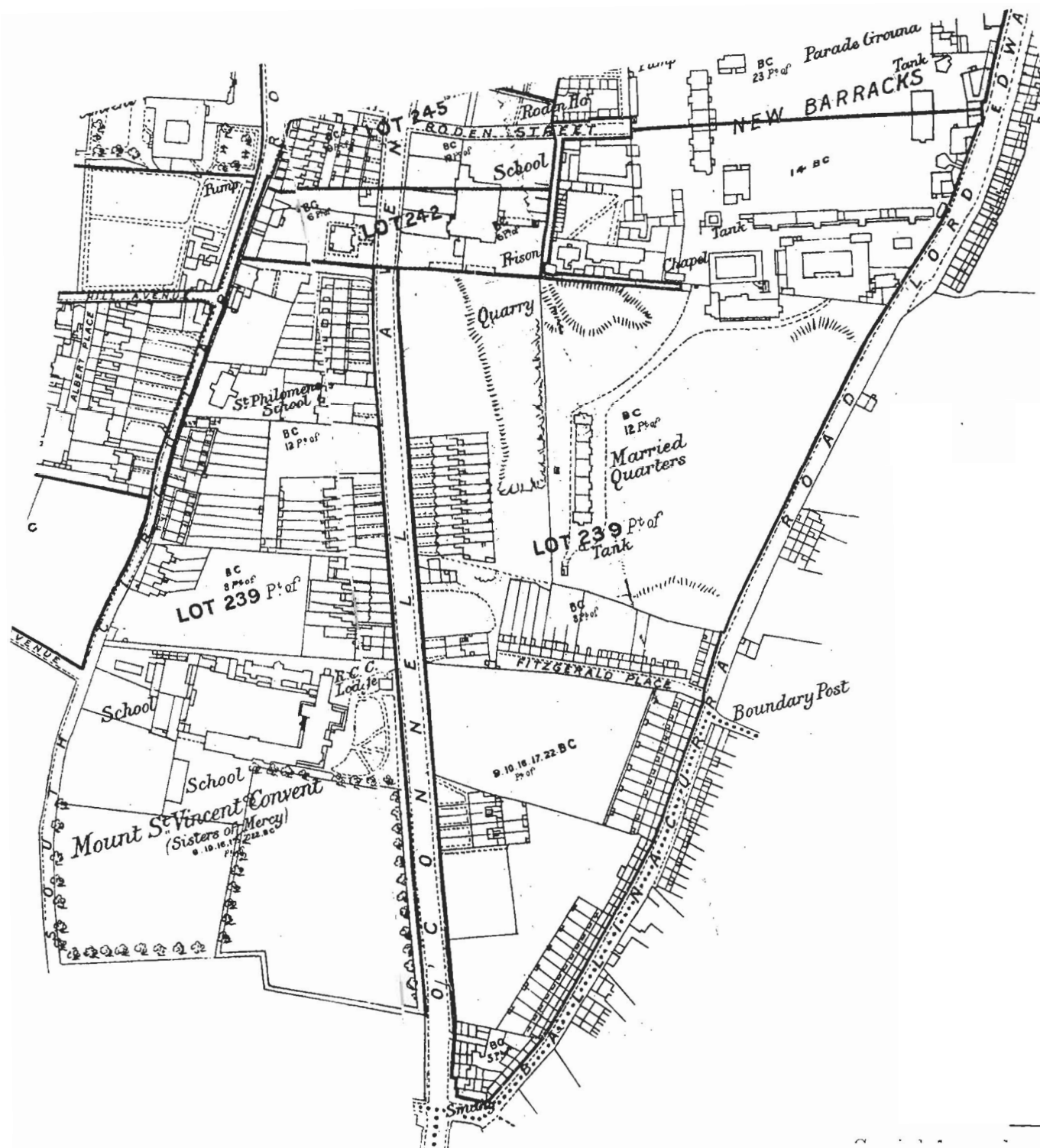

LOT 239—continued.

Nos. on Map	DENOMINATIONS	Grantees' and Lessees' Names	Gale Days	Yearly Rent	TENURE	OBSERVATIONS
				£ s. d.		
			Brought forward,	83 13 4		
Map No. 10 8 G'c	Premises in O'Connell-avenue, Rosbrien-road, Fitzgerald-place, Weston House, Biarritz, Ivy-villa, Mount Vincent-place, Hawthorn-villas, Mountam View, Sarsfield-terrace, Alpine-villas, and Building Ground	Eliza Wilhelmina Bellingham Trotman, widow	25th March and 29th Sept.	13 18 10	Fee-farm Grant, dated 21st March, 1879, made between William Hale John Charles, Earl of Limerick, of the one part, and Eliza Wilhelmina Bellingham Trotman, widow, of the other part; in conversion of a Renewable Lease, dated 11th July, 1777, from the Reverend William Cecil Pery to Burton Bindon.	<p>The rent set out in the Rent Column may be liable to adjustment under the Local Government Acts.</p> <p>The Landlord's part of the Fee-farm Grant and of the Original Lease and such of the Renewals as are forthcoming will be handed to the Purchaser.</p> <p>This rent is paid by Mr. R. V. O'Brien, Ballyalla, Ennis, Co. Clare, Agent for Grantee.</p>
					The premises are described in the Grant as "All that and those the field now and for some time past in the possession and occupation of the said Burton Bindon, being part of the lands of Ballinacurra Bowman in the Liberties of the City of Limerick, containing 3 acres and 29 perches, or thereabouts, be the same more or less."	
					The Grantee covenants to keep in repair the premises and all improvements, the accidents of fire, war and general rebellion only excepted.	
Nap No. 10 9 B'c 10 B'c 16 B'c 17 B'c 22 B'c	Mount St. Vincent Convent ... Industrial School, Widows' Alms House. Offices, Gardens and Fields Premises, O'Connell-avenue, Carlisle-terrace, Mount St. Vincent Cottages, Rosbrien-road and Building Ground	William John Geary ..	1st May and 1st Nov	7 17 6	Fee-farm Grant, dated 7th September, 1857, made between William Henry Tennison, Earl of Linierick, of the one part, and William John Geary of the other part: in conversion of a Renewable Lease, dated 1st May, 1775, from the Reverend William Cecil Pery Dean of Killaloe, to John Ewer	<p>The rent set out in the Rent Column may be liable to adjustment under the Local Government Acts.</p> <p>The Landlord's part of the Fee-farm Grant and of the Original Lease and such of the Renewals as are forthcoming will be handed to the Purchaser.</p> <p>This rent is paid by the Superioress, Sisters of Mercy, Nicholas-street, Limerick.</p>
					The premises are described in the Grant as "All that part of the lands of Ballinacurra Bowman, described in said Original Lease as being 'in the South Liberties of the City of Linierick, containing 1 acre and 2 roods, as described in a Map to said Indenture annexed, be the same more or less."	

Nos. on Map	DENOMINATIONS	Grantees' and Lessees' Names	Gale Days	Yearly Rent	TENURE	OBSERVATIONS
-------------------	---------------	------------------------------	-----------	-------------	--------	--------------

	£ s. d.
Brought forward,	105 9 8

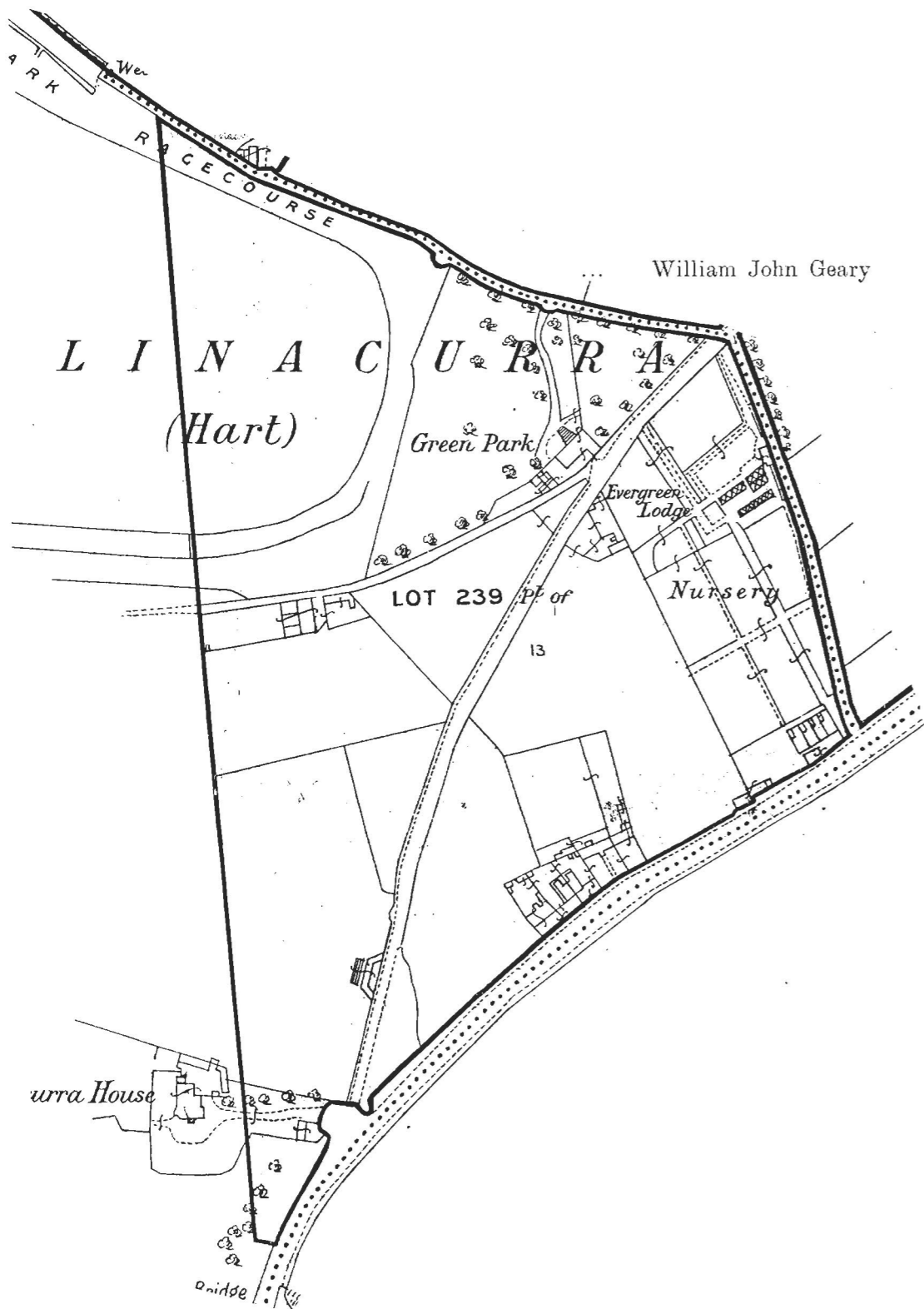

... William John Geary ...
continued

The Grant reserves all timber and timber trees, mines, minerals, coals slate and other quarries, with liberty to hunt, hawk, fish, and fowl.

The Grantee covenants to keep in repair the premises and all improvements, inevitable accidents excepted

William John Geary
1st May
and
1st Nov. 20 5 7

Fee-farm Grant, dated 2nd September, 1857 made between William Henry Tennison, Earl of Limerick, of the one part, and William John Geary of the other part; in conversion of a Renewable Lease, dated 2nd September, 1776, from the Reverend William Cecil Pery Dean of Killaloe, to Edward William Burton.

The rent set out in the Rent Column may be liable to adjustment under the Local Government Acts.

The Landlord's part of the Fee-farm Grant and of the Original Lease and such of the Renewals as are forthcoming will be handed to the Purchaser.

This rent is paid by the Superiress, Sisters of Mercy, Nicholas-street, Limerick.

The premises are described in the Grant as "All that and those that part of the lands of Ballinacurra Bowman, described in said Original Lease as being 'in the South Liberties of the City of Limerick, containing 3 acres 3 roods and 18 perches, plantation measure, be the same more or less, bounded on the East by Burton Bindon's, Esquire, fields, on the west by Sexton Baylee's, Esquire, and Matthew M'Mahon's fields, on the North by Boherglass road, and on the South by the Turnpike road,' which said premises are situate, lying and being in the Parish of Saint Michael and County of the City of Limerick."

The Grant reserves all mines, minerals and royalties, and liberty of hunting, hawking, fishing and fowling, and also all other reservations in the Original Lease, which includes a reservation of all timber and trees

The Grantee covenants to keep in repair the premises and all improvements, inevitable accidents excepted.

Clause of surrender on any 1st May or 1st November on giving six months' notice in writing under hand and seal, paying all rent.

LOT 239—continued.

Nos.
on
Map

DENOMINATIONS

Grantees' and Lessees' Names

Gale Days

Yearly Rent

TENURE

OBSERVATIONS

Brought forward, £ s. d.
125 15 3

—	...	Frederick Hobart	...	25th March and 29th Sept.	12 0 0	Lease, dated 12th August, 1852, made between William Henry Cecil Tennison, Earl of Limerick, of the one part, and Frederick Hobart of the other part, for the lives of the present King, Sir Charles Burton Barrington, and Christopher William Keays, renewable for ever on a peppercorn fine.	<p>The rent set out in the Rent Column may be liable to adjustment under the Local Government Acts.</p> <p>The Landlord's part of the Original Lease will be handed to the Purchaser.</p> <p>This rent is paid by the Superioress, Sisters of Mercy, Nicholas-street, Limerick.</p>
						<p>The premises are described in the Lease as "All that and those the lot of ground containing 2 acres 2 roods and 10 perches, late Irish plantation measure, be the same more or less, as late in the possession of Robert Langford, situate, lying and being at Ballinacurra Bowman, in the Parish of Saint Michael and within the Muncipal Boundary in the Borough of Limerick, as described on the map."</p> <p>The Lease reserves all mines, minerals and royalties.</p> <p>The Lessee covenants to keep in repair the premises and all improvements.</p> <p>The Lease contains a covenant for perpetual renewal by the Grantor on payment of a peppercorn fine.</p>	
—	...	The Most Rev. Edward T. O'Dwyer, Roman Catholic Bishop of Limerick, and others		25th March and 29th Sept.	7 16 3	Fee-farm Grant, dated 22nd March, 1890, made between William Hale John Charles, Earl of Limerick, of the one part, and the Most Revd. Edward O'Dwyer, Roman Catholic Bishop, the Reverend James O'Shea, Roman Catholic Administrator, and Mrs. Mary Anne Kenny, Superioress of the Community of Sisters of Mercy in the City of Limerick, of the other part, in conversion of a Renewable Lease, dated 1st June, 1843, from Henry, Earl of Limerick, to Robert Keays.	<p>The rent set out in the Rent Column may be liable to adjustment under the Local Government Acts.</p> <p>The Landlord's part of the Fee-farm Grant and of the Original Lease will be handed to the Purchaser.</p> <p>This rent is paid by the Superioress, Sisters of Mercy, Nicholas-street, Limerick.</p>

Nos.
on
Map

DENOMINATIONS

Grantees' and Lessees' Names

Gale Days

Yearly Rent

TENURE

OBSERVATIONS

Brought forward, £ s. d.
145 11 6

<p>—</p>	<p>...</p>	<p>The Most Rev. Edward T. O'Dwyer, Roman Catholic Bishop of Limerick, and others, continued.</p>	<p></p>	<p></p>	<p>The premises are described in the Grant as "All that and those 2 lots or pieces of ground, containing 1 acre, late Irish plantation measure, be the same more or less, as late in the possession of the Representatives of Thomas Burke and his undertenants, situate, lying and being at Ballinacurra Bowerman, in the Parish of Saint Michael within the Municipal Boundary of the Borough of Limerick, as more particularly described on the Map to said Original Lease."</p> <p>The Grantees covenant to keep in repair the premises and all improvements.</p>	<p></p>
<p>—</p>	<p>...</p>	<p>William John Geary</p>	<p>1st May and 1st Nov.</p>	<p>S 1 6</p>	<p>Fee-farm Grant, dated 7th September, 1857, made between William Henry Tennison, Earl of Limerick, of the one part, and William John Geary of the other part; in conversion of a Renewable Lease, dated 20th June, 1798, from Edmond Lord Baron Glentworth to Joseph Gabbett.</p> <p>The premises are described in the Grant as "All that and those part of the lands of Ballinacurra Bowman, described in said Original Lease as being 'then lately held by Francis Sergent Peter, Esquire, containing by common estimation 1a. 2r. 6p., plantation measure, be the same more or less, bounded on the East by Edmond William Burton's Esquire, holdings, on the West by Mr. John Ewer's holdings, on the North by the Circular-road, and on the South by Mr. Denis Kennedy's holdings, situate, lying and being in the South Liberties of the City of Limerick.'"</p> <p>The Grantee covenants to keep in repair the premises and all improvements, inevitable accidents excepted.</p>	<p>The rent set out in the Rent Column may be liable to adjustment under the Local Government Acts.</p> <p>The Landlord's part of the Fee-farm Grant and of the Original Lease will be handed to the Purchaser.</p> <p>This rent is paid by the Superioress, Sisters of Mercy, Nicholas-street, Limerick.</p>

LOT 239—continued.

Nos on Map	DENOMINATIONS	Grantees' and Lessees' Names	Gale Days	Yearly Rent	TENURE	OBSERVATIONS
				£ . s. d. Brought forward, 153 13 0		
Map No. 11 11 B'e	Lifford House and Grounds ... Premises, Sydenham-terrace, County View-terrace, Saint Mary's-terrace, and Lifford-terrace	Thomas Stuart	25th March and 29th Sept.	25 4 10	Lease, dated 24th March, 1791, made between Edmond Henry Pery, of the one part, and Thomas Stuart of the other part, for the term of 988 years, from the 25th March, 1791. The premises are described in the Lease as "All that and those that part of the lands of Ballinacurra Bowman, in the South Liberties of the City of Limerick, containing 7 acres, 1 rood and 17 perches, be the same more or less, bounded on the North by Boherglass road, on the South by the turnpike road, on the East by Mr. Thomas Roberts, deceased's fields, and on the West by the new road leading from Boherglass road to the turnpike road, in as full and ample a manner as Mathew Honan, of the City of Limerick, merchant, held the same." The Lessee covenants to keep in repair the premises and all improvements. The Lease contains a clause of surrender on any 25th March, on twelve months' notice in writing, duly attested, paying rent.	The rent set out in the Bent Column is an adjusted rent. The Landlord's part of the Original Lease will be handed to the Purchaser. This rent is paid by Captain D'Esterre, Rossmanagher, Sixmilebridge, Limerick.
Nap No. 10 12 B'e	O'Connell-avenue, late Military-road .. Portion of New Barracks Premises, comprising Ascot-terrace, Mount Vincent-terrace, Eagle Lodge, Albcr-t-villa, Clare View, Swanson- terrace, Courtbrack House, Green- ville, Somerville-terrace, Belvue- terrace, Couvent School, Foley's- terrace, and valuable building ground	Michael Fitzgerald ...	25th March and 29th Sept.	48 18 5½	Fee-farm Grant, dated 18th May, 1853, made between William Henry Tennison, Earl of Limerick, of the one part, and Michael Fitzgerald of the other part, in conversion of a Renewable Lease, dated 1st May, 1775, from the Reverend William Cecil Pery to Walter Widdenham. The premises are described in the Grant as "All that part of the Lands of Ballinacurra Bowman, formerly in the possession of said Walter Widdenham, containing 10 acres 3 roods and 31 perches, late Irish plantation measure (equal	The rent set out in the Rent Column may be liable to adjustment under the Local Government Acts. The Landlord's part of the Fee-farm Grant and such of the Renewals as are forthcoming will be handed to the Purchaser. The Landlord's part of the Original Lease is not forthcoming. This rent is paid by Mr. John Dundon, Solicitor, O'Connell-street, Limerick, Agent for the Grantee.

LOT 239—continued.

Nos. on Map	DENOMINATIONS	Grantees' and Lessees' Names	Gale Days	Yearly Rent	TENURE	OBSERVATIONS
Map No. 10 12 Bc. contd.	—	.. Michael Fitzgerald, contd	Brought forward,	<div style="display: flex; justify-content: space-between; font-size: small;"> £ s. d. </div> 227 16 3½	<p>to 18 acres 2 roods and 35 perches, statute measure), be the same more or less, bounded on the East by part of the holdings formerly belonging to said Dean Pery, on the West by holdings, formerly belonging to William Keegan, on the North by Boherglass, and on the South by the road leading to Ballinacurra Turnpike, and situate, lying and being in the Parish of Saint Michael, and South Liberties of the City of Limerick."</p> <p style="text-align: center;">*</p> <p>The Grant reserves all timber and timber trees, mines, minerals, coal, slate, and other quarries, and also reserves liberty to hunt, hawk, fish, and fowl.</p> <p>Covenant that Grant was subject to covenants in Original Lease, save covenant for renewal.</p>	
Nap No. 11 13 B'c	Portion of Premises of Limerick Race Co., Ltd. Greenpark House Griffin's Nurseries Premises, Ballinacurra-terrace, Ferndale-terrace, Greenpark-villas, Vokes'-cottages, Brookville-terrace, May-villa, Eden-villas	James Mahoney Harte . and Keverend William Harte ..	26th March and 29th Sept.	10 4 8	Fee-farm Grant, dated 20th November, 1860, made between William Henry Tennison, Earl of Limerick, of the one part, and James Mahoney Harte, commonly called Mahoney Harte, and the Reverend William Harte of the other part, in conversion of a Renewable Lease, dated 1st August, 1775, from William Cecil Pery. Dern of Killaloe, to Richard Harte.	<p>The rent set out in the Rent Column may be liable to adjustment under the Local Government Acts.</p> <p>The Landlord's part of the Fee-farm Grant and of the Original Lease and such of the Renewal as are forthcoming will be handed to the Purchaser,</p> <p>This rent is paid by Mrs. McDonnell, Ballinacurra House, Limerick.</p> <p>These premises, although originally part of Ballinacurra Bowman, are included by the Ordnance as part of Ballinacurra Harte.. The area of the holding is about 34 statute acres.</p>

Nos. on Map	DENOMINATIONS	Grantees' and Lessees' Names	Gale Days	Yearly Rent	TENURE	OBSERVATIONS
Map No 11 13 B'e contd.		James Mahoney Harte ... and Reverend William Harte ... continued	Brought forward, £ s. d. £297 0 11½		Indenture of Lease, as bounded on the East by part of said Dean Pery's holdings, on the West by said Richard Harte's holdings, on the North by Boherglass, and on the South by the road leading to Ballinacurra Turnpike, which said premises were formerly in the South Liberties of the City of Limerick, but are now situate in the Barony of Pubblebrien. and County of Limerick."	
					The Grant reserves all timber, and timber trees, mines, minerals, coal, slate, and other quarries, with liberty to hunt, hawk, fish and fowl.	
					The Grantees covenant to keep in repair all houses, buildings, edifices, quicksets, drains, fences, and other improvements, accidents of fire, war, and general rebellion excepted.	
					Proviso that Grant was subject to all provisions contained in head Lease from Benjamin Swete to Edy Bowman.	
Map No. 10 14 B'e	Part of the New Barracks	Richard B. Lloyd	25th March and 29th Sept.	18 9 3	Fee-farm Grant, dated 7th November, 1839, made between William Henry Tennison, Earl of Limerick, of the one part, and Richard U. Lloyd of the other part, in conversion of a Renewable Lease, dated 21st October, 1806, from Edmond Henry, Earl of Limerick, to William Monsell.	The rent set out in the Rent Column may be liable to adjustment under the Local Government Acts. The Landlord's part of the Fee-farm Grant and of the Original Lease and such of the Renewals as are forthcoming will be handed to the Purchaser. This rent is paid by Mrs. Lloyd, 13 Pembridge Crescent, London.
					The premises are described in the Grant as "All that part of the Lands of Ballinacurra Bowman, described in said Original Lease as 'formerly in the possession of James Deely, containing by common estimation 4 acres 1 rood and 22 perches, profitable land plantation measure, be the same more or less, bounded on the South by the Turnpike road, leading from the City of Limerick to Ballinacurra, on the North by	

LOT 239—continued.

Nos. on Map	DENOMINATIONS	Grantees' and Lessees' Names	Gale Days	Yearly Rent	TENURE	OBSERVATIONS
				£. s. d. Brought forward, 315 10 29		
Map No. 10 14 Bc	---	Richard B. Lloyd, continued			<p>Mr. Austin Fitzgerald's holdings, on the East by _____ holdings, and on the West by Walter Widdenhams holdings, in as large and ample manner as the same were held and enjoyed by the said James Deely, and those deriving under him, situate, lying, and being in the South Liberties of the City of Limerick."</p> <p>The Grant reserves liberty to hunt, hawk, fish and fowl and also rescrvss all mines, minerals and coals.</p> <p>The Grantee covenants to keep in repair the premises and all improvements.</p>	
Map No. 11 15	Premises, New-street, Washington-terrace, Rose-terrace, Geraldine-place, Annie-terrace	Reverend George Washington Biggs	1st May and 1st Nov.	9 15 6	<p>Fee-farm Grant, dated 11th February, 1903, made between William Henry Edmond de Vere Sheaffe, Earl of Limerick, of the one part, and the Reverend George Washington Biggs of the other part, in conversion of a Renewable Lease, dated 1st May, 1783, from Edmond Henry Pery to Richard England.</p> <p>The premises are described in the Grant as "All that and those that part of Ballynacurra Bowman, containing 2 acres 1 rood and 31 perches, be the same more or less, bounded on the East by Mr. Ewer's holdings, on the West by Oliver O'Brien's holdings, on the North by Boherglass road and on the South by John Ryan and Mr. Edward Prestwitch's holdings, situate in the South Liberties of the City of Limerick, and now known as the New street, in the Parish of Saint Michael and City of Limerick."</p> <p>The Grantee covenants to keep in repair the premises and all improvements.</p>	<p>The rent set out in the Rent Column is an adjusted rent.</p> <p>The Landlord's part of the Fee-farm Grant and of the Original Lease and such of the Renewals as are forthcoming will be handed to the Purchaser.</p> <p>This rent is paid by Messrs. E. L. Hunt & Sons, Glentworth-street, Limerick, Agents for the Grantee.</p>

LOT 239—continued.

Nos. on Map	DENOMINATIONS	Grantees' and Lessees' Names	Gale Days	Yearly Rent	TENURE	OBSERVATIONS
				£ s. d. Brought forward, 326 5 84		
Map No. 11 20 B'c	Southville Rouse, Offices and Land ...	Bernard Cavanagh and Mary Cavanagh	25th March and 29th Sept.	13 16 0	Fee-farm Grant, dated 23rd March, 1858, made between William Henry Tennison, Earl of Limerick, of the one part, and Bernard Cavanagh and Mary Cavanagh, his wife, of the other part; in conversion of a Renewable Lease, dated 14th July, 1794, from Edmond Lord Baron Glentworth to Robert Lynch.	The rent set out in the Rent Column is an adjusted rent. The Landlord's part of the Fee-farm Grant and of the Original Lease and such of the Renewals as are forthcoming will be handed to the Purchaser. This rent is paid by Dr. M. J. Malone, Pery-square Limerick.
					The premises are described in the Grant as "All that and those the said part of the lands of Ballinacurra Bowman.. in that part of the South Liberties of the City of Limerick, now or lately annexed under the Municipal Boundary Act to the Barony of Pubble Brien, in the County of Limerick, containing 3 acres, 1 rood and 20 perches, be the same more or less, and which premises are described in the said Recited Original Lease as being bounded on the East by a new stone wall, on the West by Houlihan's tillage, on the North by the green road, and on the South by the turnpike road."	
					The Original Lease reserves all timber and other trees, mines, minerals, coal, slate and other quarries.	
					The Grantees covenant to keep in repair all houses, buildings, edifices, quicksets, drains, fences, and other improvements, the accidents of fire, war and general rebellion only excepted.	
					Covenant by Grantees to be bound by all covenants and clauses in the head Lease of the premises.	
				£339 1 8½		
	Deduct			£137 7 8		
	Head Rent adjusted	...				
	Quit. Rents	£1 4 7				
		1 8 2				
		1 16 9				
		£4 9 6				
	Fixed annual instalment for tithe rentcharge ...	0 6 5				
		4 15 11				
				£142 3 7		
				£196 18 1½		

This lot is sold subject to the entire Head Rent reserved by the Fee-farm Grant of 7th September, 1857, and bound to indemnify all other premises subject thereto therefrom. This lot is also sold subject to the Quit Rents and fixed annual instalment for tithe rentcharge payable out of the said Lands of Ballinacurra (Bowman) and bound to indemnify all other premises subject thereto therefrom.

See Special Conditions of Sale relating to this lot.

The Estimated Tenement Valuation of this lot is £4,174 5s.